

BM BM\* P.C.S.B. 40' Mark and 40' East intersection 30' Sd and Sierra Way E.L. 1017.72 M.S.L.

Sierra Way

**GENERAL NOTES**

1. All work embodied in these plans shall be done in conformity with applicable provisions of the State of California, Department of Public Works, Division of Highways Specifications Dated August 1954.
2. Trees and Brick Building shall be removed from right-of-way by others.
3. Power poles and down guys shall be removed from right-of-way by others.

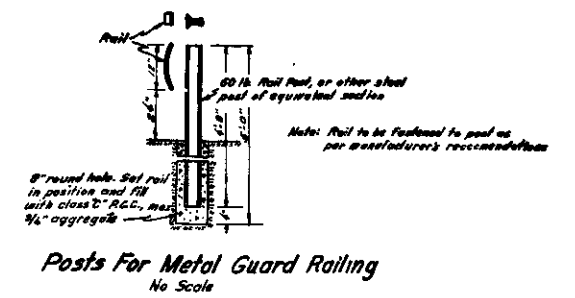
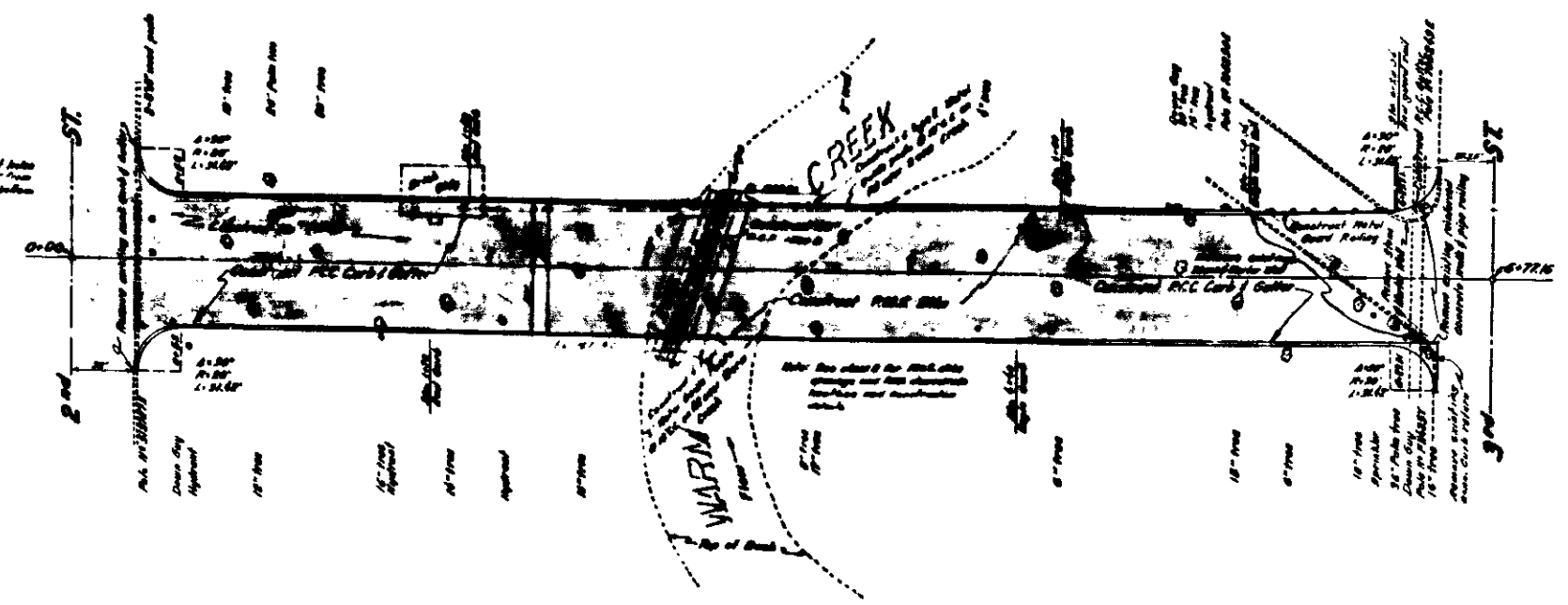
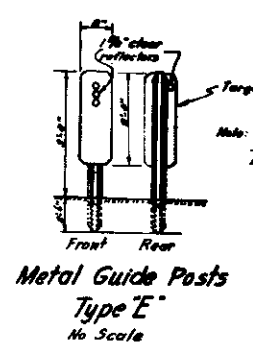

DEPARTMENT OF ENGINEERING  
CITY OF SAN BERNARDINO

**SIERRA WAY**  
2<sup>nd</sup> Street to 3<sup>rd</sup> Street

SUBMITTED BY	REFERENCE	DRAWN
APPROVED BY November 26, 1954 Ronald S. Wilson CITY ENGINEER	DRAWN BY c.l.c.	2476

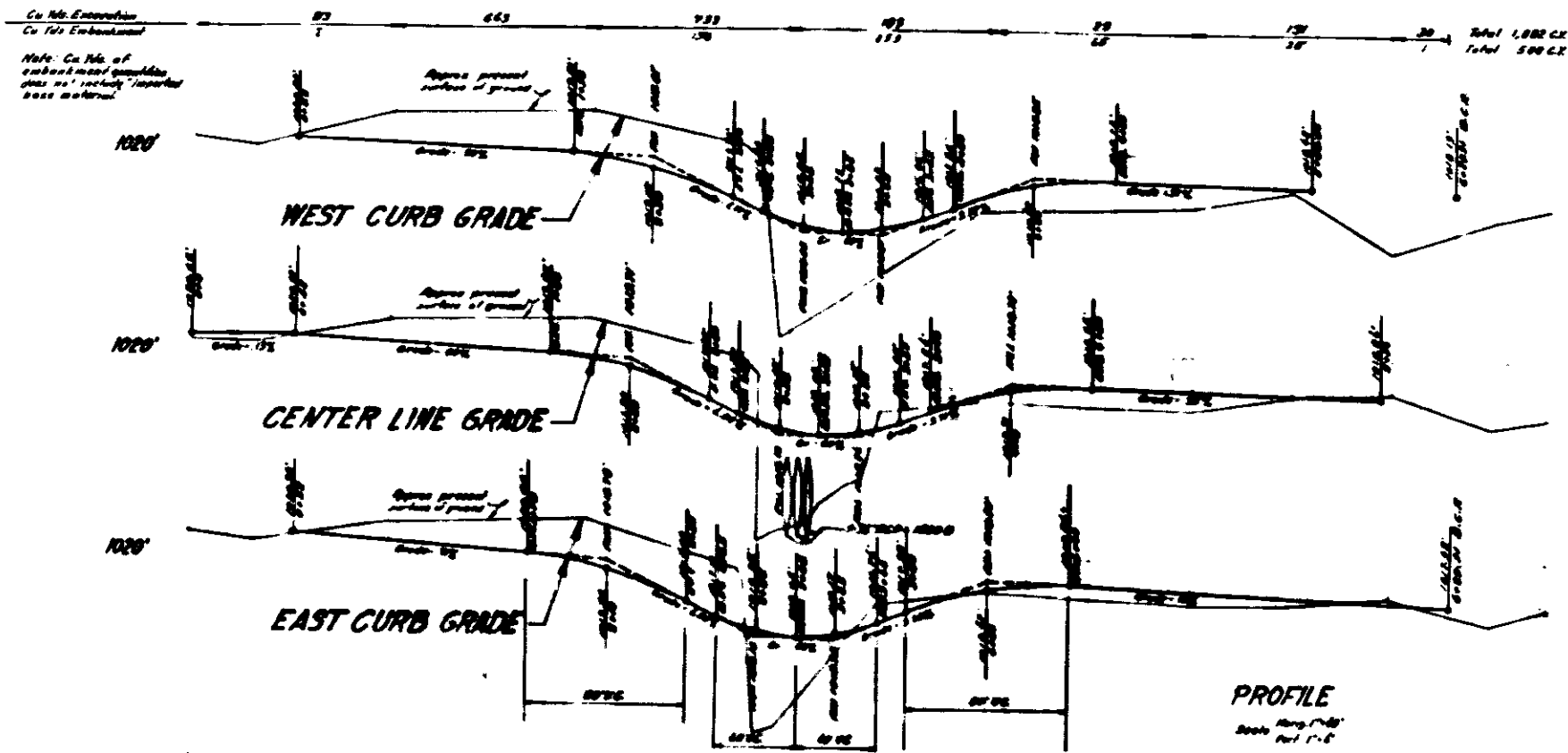

BM BM\* P.C.S.B. 40' North and 40' East intersection 30' 54" and Sierra Way E.L. 1017.72 M.S.L.

Sierra Way

**GENERAL NOTES**

1. All work embodied in these plans shall be done in conformity with applicable provisions of the State of California, Department of Public Works, Division of Highways Specifications Dated August 1954.
2. Trees and Brick Building shall be removed from right-of-way by others.
3. Power poles and down guys shall be removed from right-of-way by others.

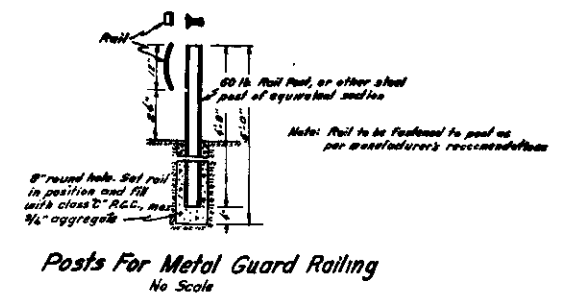
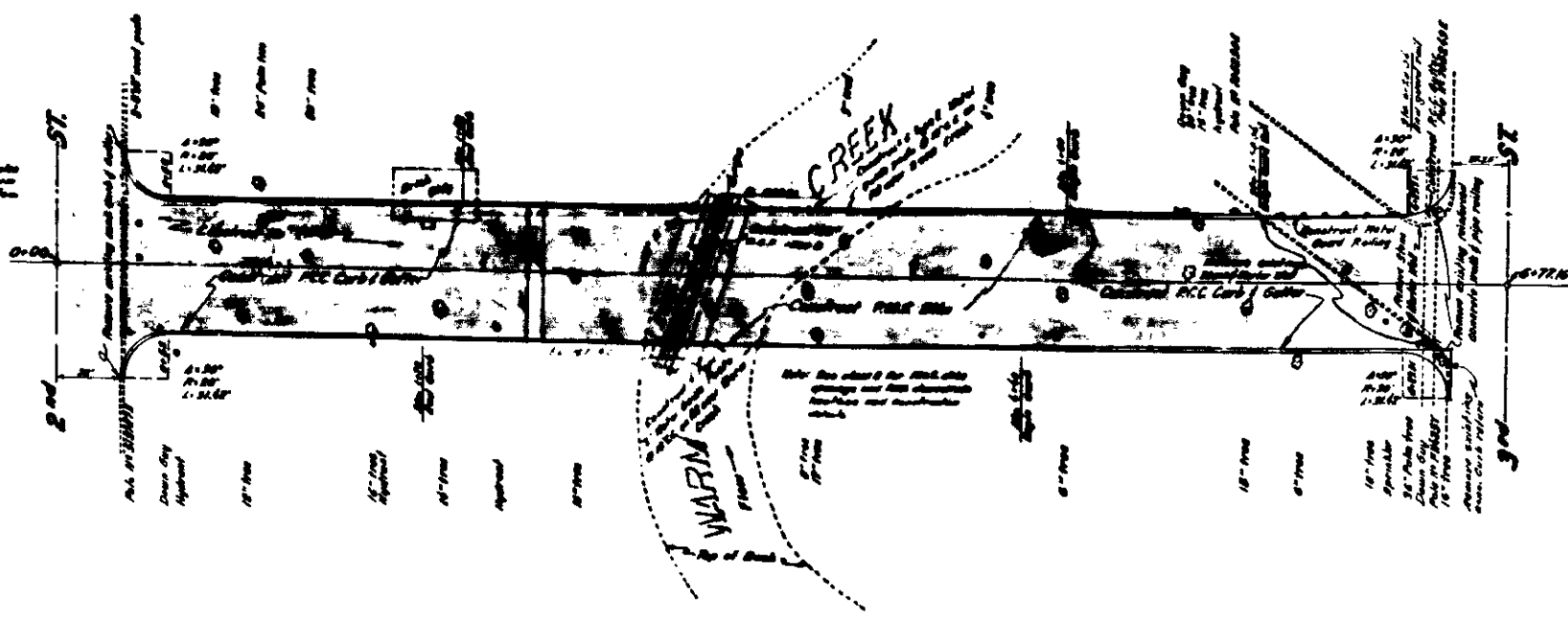
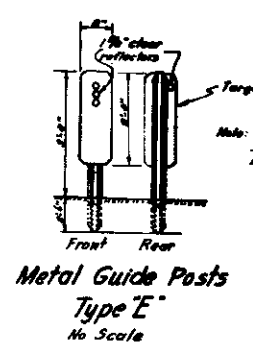

DEPARTMENT OF ENGINEERING  
CITY OF SAN BERNARDINO

**SIERRA WAY**  
2<sup>nd</sup> Street to 3<sup>rd</sup> Street

SUBMITTED BY	REFERENCE	DRAWN
APPROVED BY November 26, 1954 Ronald S. Wilson CITY ENGINEER	DRAWN BY c.l.c.	2476